

Technical Datasheet



COOLING TOWER

For Pressure Devices

Key Features

- All 316L St.St. construction
- Exotic material available as option
- Connections G1/2B (1/2"G or BSP) or 1/2" –14 NPT
- Compact, single piece construction
- Weight approx. 0.2 kg with 5 fins
- Max process pressure 600bar
- Max process temperature 200°C



Series Overview

The cooling tower, is a simple device largely used to protect the instrument from excessive process temperatures.

The high temperature of the process fluid is reduced by the radiation of heat and circulation of air through the cooling fins.

The temperature of the fluid is therefore lowered sufficiently so the temperature limits of the connected instrument are not exceeded. In addition any possible measurement errors linked to the temperature are consequently reduced.

At the ambient temperature condition of 20°C, it reduces the temperature of the fluid from 200°C to approx. 70°C.

The use of the cooling tower, extends the working life of the instrument, and enables a direct connection where fluids are up to 200°C.

Product applications

- Oil & gas, Chemical and Petrochemical
- Gas and liquids
- Applicable on any type of pressure instruments
- Standard wetted parts are in SS316. Wetted parts material in accordance with NACE are available as extra.

Other products

Other products we can offer :

- Overrange protectors
- Needle valves
- Syphons



How can we help you?

Delta Mobrey offers fast, efficient and knowledgeable support when and where you need it. Please visit our website at www.delta-mobrey.com to find your local support centre or call us on: **+44 (0)1252 729140**

Cooling Tower
Series CT

How to order

The instrument can be configured by selecting the codes representing the desired features from the tables below. The chart below, describes how the model code is built up. For assistance in configuring a device that best suits your needs, please contact your local sales office.

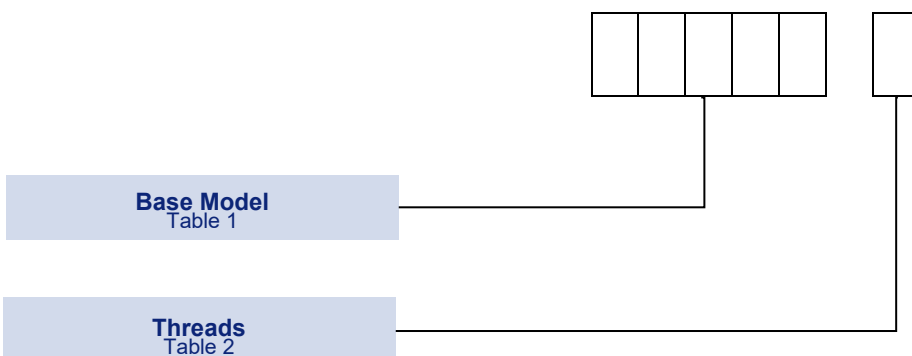

Models

TABLE 1

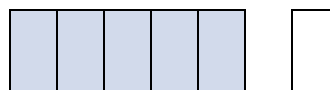

Description	Code
Cooling Tower in Stainless Steel 316	CT316
Cooling Tower in exotic material (on request)	CTXXX

Threads

TABLE 2

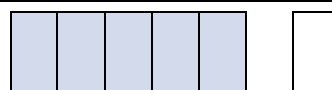

Description	Code
1/2inch NPT MxF	N
1/2inch GAS (or BSP) MxF	G

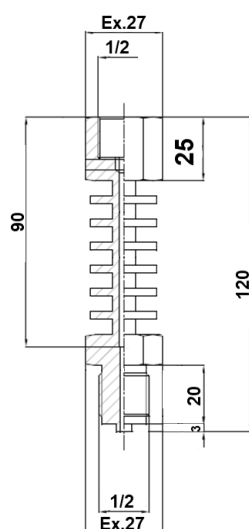

internal hole: approx. 4mm.

In the interest of development and improvement Delta Mobrey Ltd, reserves the right to amend, without notice, details contained in this publication. No legal liability will be accepted by Delta Mobrey Ltd for any errors, omissions or amendments.

Delta Mobrey Limited

Hudson House, Albany Park Camberley Surrey, GU16 7PL, UK.

T+44 (0)1252 729140 F+44 (0)1252 729168 E sales@delta-mobrey.com W www.delta-mobrey.com



FM00720

Page 2 of 2